

**NOTES:**

1' CONTOURS ARE FROM AVAILABLE COUNTY GIS DATA.

THE EDGE OF FLOODPLAIN ELEVATION ILLUSTRATED IS APPROXIMATELY 821.00

A FORMAL SURVEY WILL BE COMPLETED PRIOR TO THE DEVELOPMENT OF DETAILED CONSTRUCTION PLANS FOR THE BRIDGE REPLACEMENTS, NEW OVERLOOKS, & TRAIL WORK.

**EXISTING CONDITION NOTES**

- |                           |                                  |
|---------------------------|----------------------------------|
| ① PARKING LOT, 78 SPACES  | ⑪ PEDESTRIAN BRIDGE (3 TOTAL)    |
| ② 4 ACCESSIBLE VAN SPACES | ⑫ DOCK                           |
| ③ NATURE CENTER           | ⑬ SMALL DAM                      |
| ④ ASPHALT PATH            | ⑭ POWER LINES                    |
| ⑤ NATURE TRAIL            | ⑮ POWER LINE TOWER               |
| ⑥ FOREST                  | ⑯ APPROX. EDGE OF FLOODPLAIN     |
| ⑦ NO MOW AREA             | ⑰ GATED SERVICE PATH             |
| ⑧ MOWED TURF              | ⑱ FENCED DEER EXCLOSURE          |
| ⑨ TRAILHEAD               | ⑲ BENCH TO BE RELOCATED, 8 TOTAL |
| ⑩ OBSERVATION DECK        | ⑳ TILE FIELD                     |

**EXISTING CONDITIONS PLAN**

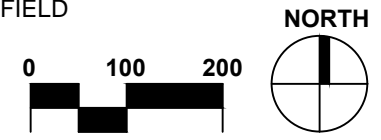

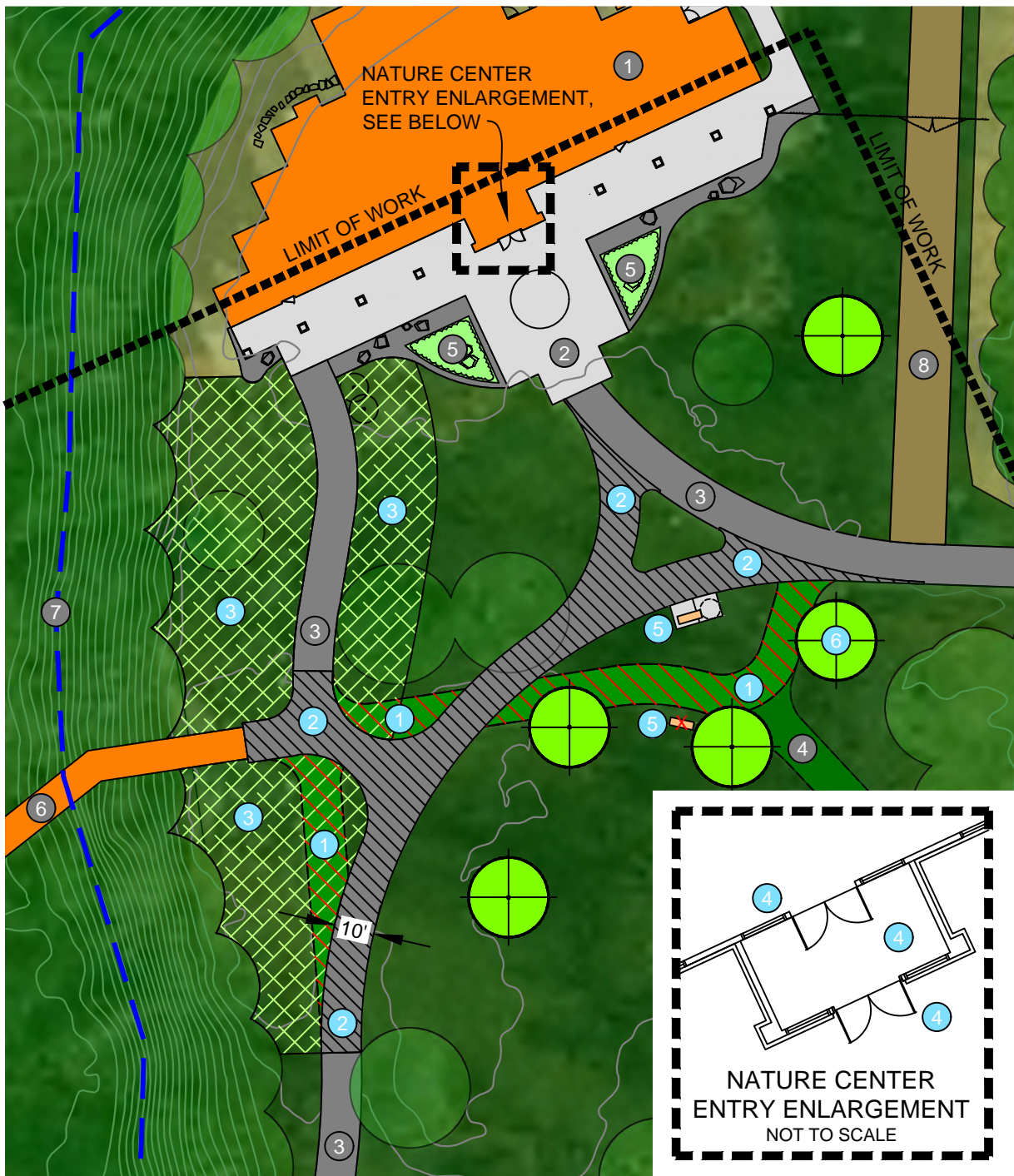

**EXISTING CONDITION NOTES**

- ① NATURE CENTER
- ② CONCRETE WALKS
- ③ ASPHALT PATH TO REMAIN
- ④ OLD TRAIL RECENTLY RESTORED WITH TURF
- ⑤ LANDSCAPE BED
- ⑥ ELEVATED OBSERVATION DECK
- ⑦ APPROX. EDGE OF FLOODPLAIN
- ⑧ SERVICE DRIVE

**PROPOSED WORK**

- ① ASPHALT PATHS TO BE REMOVED & RESTORED WITH TOPSOIL & SEED. THE WALKS ARE REMNANTS OF OLD CIRCULATION PATHS TO THE PREVIOUS NATURE CENTER.
- ② NEW 10' WIDE UA ASPHALT TRAIL. ALIGNMENT WILL IMPROVE FLOW TO ALL NATURE TRAILS THAT BEGIN AT THE EXISTING TRAILHEAD.
- ③ SEEDED PRAIRIE PLANTINGS, 6,900 SF. CURRENT INTERPRETIVE PROGRAMS ARE OFFERED ON REMOTE SECTIONS OF TRAIL. PLANTING BEDS WILL CREATE PROGRAM OPPORTUNITIES CLOSE TO NATURE CENTER.
- ④ AUTOMATIC PUSH BUTTON DOORS TO BE ADDED AT THE ENTRANCE TO THE NATURE CENTER. PUSH BUTTON DOORS CURRENTLY EXIST AT THE SIDE DOORS TO THE RESTROOMS BUT NOT THE MAIN ENTRANCE. PUSH BUTTONS NEEDED ON THE EXTERIOR OF THE BUILDING, WITHIN THE VESTIBULE & ON THE INTERIOR OF THE BUILDING. LOCATION & TYPE OF OPENERS TO BE DETERMINED.
- ⑤ EXISTING BENCH TO BE RELOCATED. BENCH TO BE PLACED ON CONCRETE PAVEMENT WITH WHEELCHAIR SPACE LOCATED TO ONE SIDE.
- ⑥ NATIVE TREE PLANTINGS, 5 TOTAL

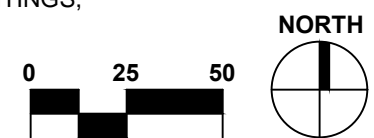
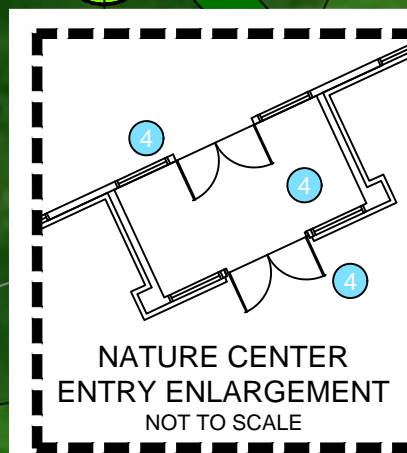

**ASPHALT PATH & NATURE CENTER ENTRY ENLARGEMENT**

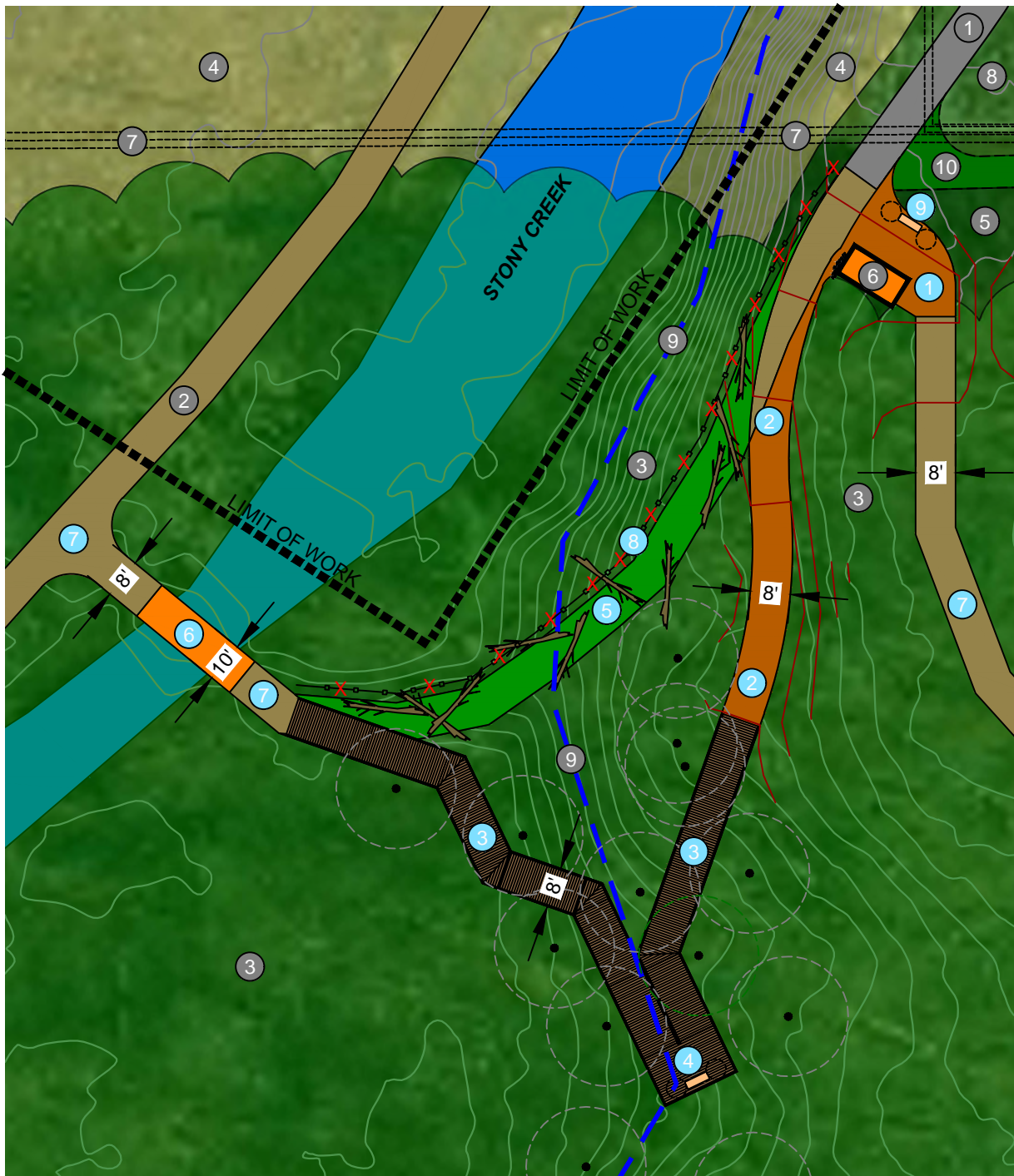

**EXISTING CONDITION NOTES**

- 1 ASPHALT PATH
- 2 NATURE TRAIL TO REMAIN AS IS
- 3 FOREST
- 4 NO MOW AREA
- 5 MOWED TURF
- 6 TRAILHEAD
- 7 POWER LINES
- 8 POWER LINE TOWER
- 9 APPROX. EDGE OF FLOODPLAIN
- 10 OLD TRAIL RECENTLY RESTORED WITH TURF

**PROPOSED WORK**

- 1 PLACE 21AA AGGREGATE WITH FINES AT TRAILHEAD. REGRADE FOR UA WITH SLOPES NO GREATER THAN 2% IN BOTH DIRECTIONS IN FRONT OF EXISTING SIGN.
- 2 ADJUST ALIGNMENT & GRADE OF EXISTING AGGREGATE PATH (+/-22% SLOPE). THE NEW UA 8' WIDE 21AA AGGREGATE PATH WITH FINES NOT TO EXCEED 5% RUNNING SLOPE & 2% CROSS PITCH.
- 3 8' WIDE UA BOARDWALK WITH HANDRAIL ON BOTH SIDES. SLOPES NOT TO EXCEED 5%. BOARDWALK TO ZIGZAG AVOIDING LARGE EXISTING TREES. SURVEY TO BE COMPLETED.
- 4 SURFACE MOUNTED BENCHES AT FLAT SWITCHBACK SECTION OF BOARDWALK
- 5 RESTORE EXISTING PATH WITH TOPSOIL, FALLEN TREES, & DEBRIS FROM SOIL FLOOR.
- 6 PREFABRICATED BRIDGE WITH RAILINGS TO REPLACE THE EXISTING PEDESTRIAN BRIDGE #1
- 7 ADJUST WIDTH & SLOPE OF EXISTING TRAIL AS NEEDED TO MEET UA TRAIL REQUIREMENTS
- 8 REMOVE EXISTING SPLIT RAIL FENCE
- 9 RELOCATE EXISTING BENCH

**BOARDWALK & BRIDGE #1 ENLARGEMENT**

Stony Creek Metropark - LW22-0003 Reflection Trail Improvements

January 2022

3 OF 9



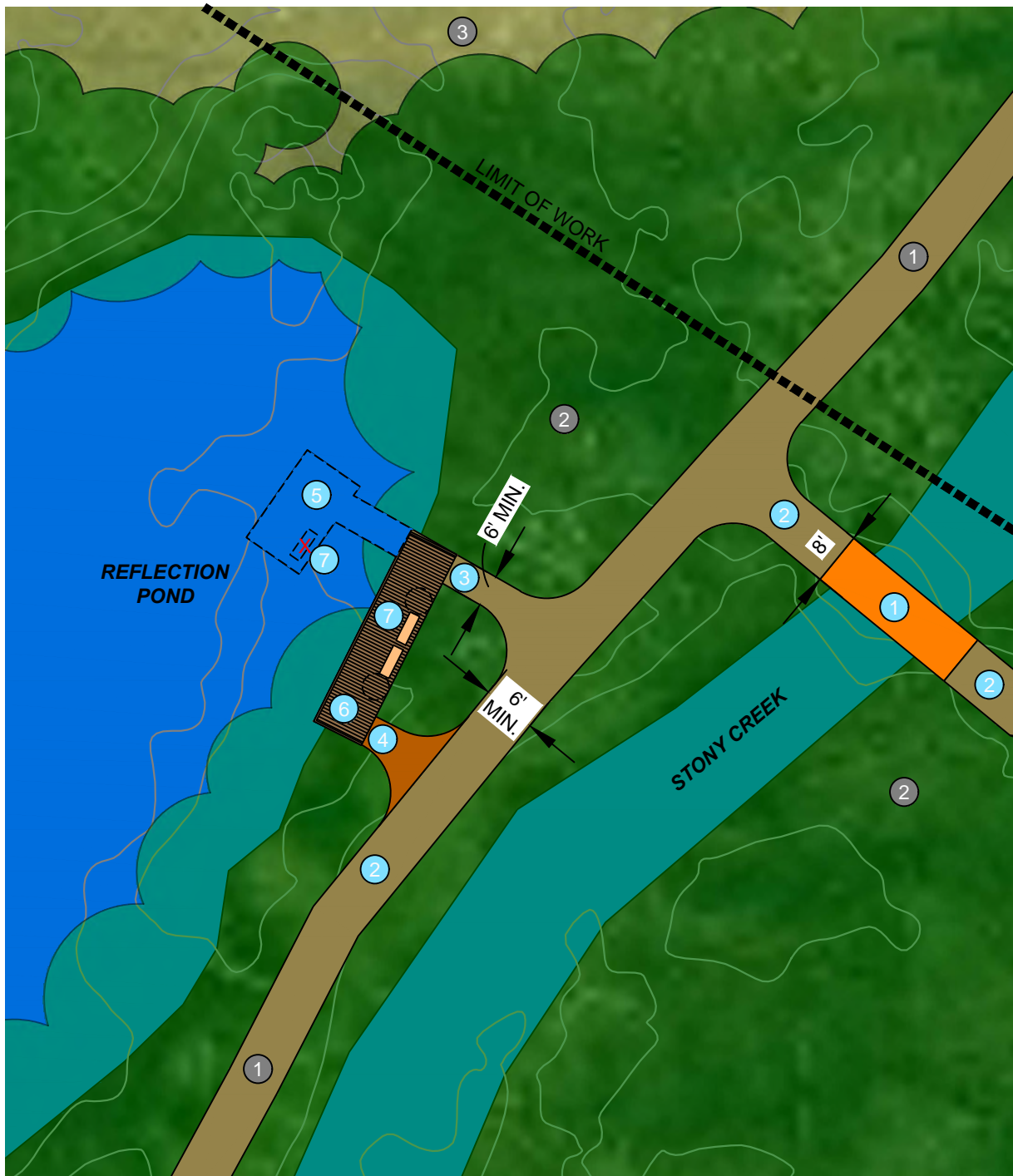

**EXISTING CONDITION NOTES**

- ① NATURE TRAIL
- ② FOREST
- ③ NO MOW AREA

**PROPOSED WORK**

- ① PREFABRICATED BRIDGE WITH RAILINGS TO REPLACE EXISTING PEDESTRIAN BRIDGE #1
- ② ADJUST GRADE OF EXISTING AGGREGATE PATH. THE 6' & 8' WIDE UA 21AA AGGREGATE PATHS WITH LIMESTONE FINES SHALL NOT EXCEED 5% RUNNING SLOPE & 2% CROSS PITCH.
- ③ ADJUST WIDTH & GRADE OF EXISTING PATH TO NEW OVERLOOK. THE SHORT UA PATHS SHALL BE 6' WIDE & CONSTRUCTED OF 21AA AGGREGATE WITH LIMESTONE FINES. TRANSITION ON TO THE PLATFORM SHALL NOT EXCEED 1/2".
- ④ NEW ACCESS POINT FOR THE PROPOSED POND OVERLOOK. REMOVE EXISTING VEGETATION AS NEEDED. THE UA PATH SHALL BE 6' WIDE & CONSTRUCTED OF 21AA AGGREGATE WITH LIMESTONE FINES. TRANSITION ON TO THE PLATFORM SHALL NOT EXCEED 1/2".
- ⑤ REMOVE EXISTING ACCESS PATH & DOCK
- ⑥ 10' X 30' OVERLOOK STRUCTURE WITH WHEELCHAIR GUARDS (NO RAILING).
- ⑦ RELOCATE THE EXISTING 6' SURFACE MOUNTED BENCH ON THE DOCK TO THE NEW OVERLOOK STRUCTURE. ADD ONE ADDITIONAL 6' SURFACE MOUNTED BENCH. WHEELCHAIR SPACES SHALL BE PROVIDED TO THE SIDE OF BOTH BENCHES.

**POND OVERLOOK STRUCTURE**

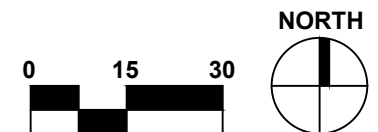

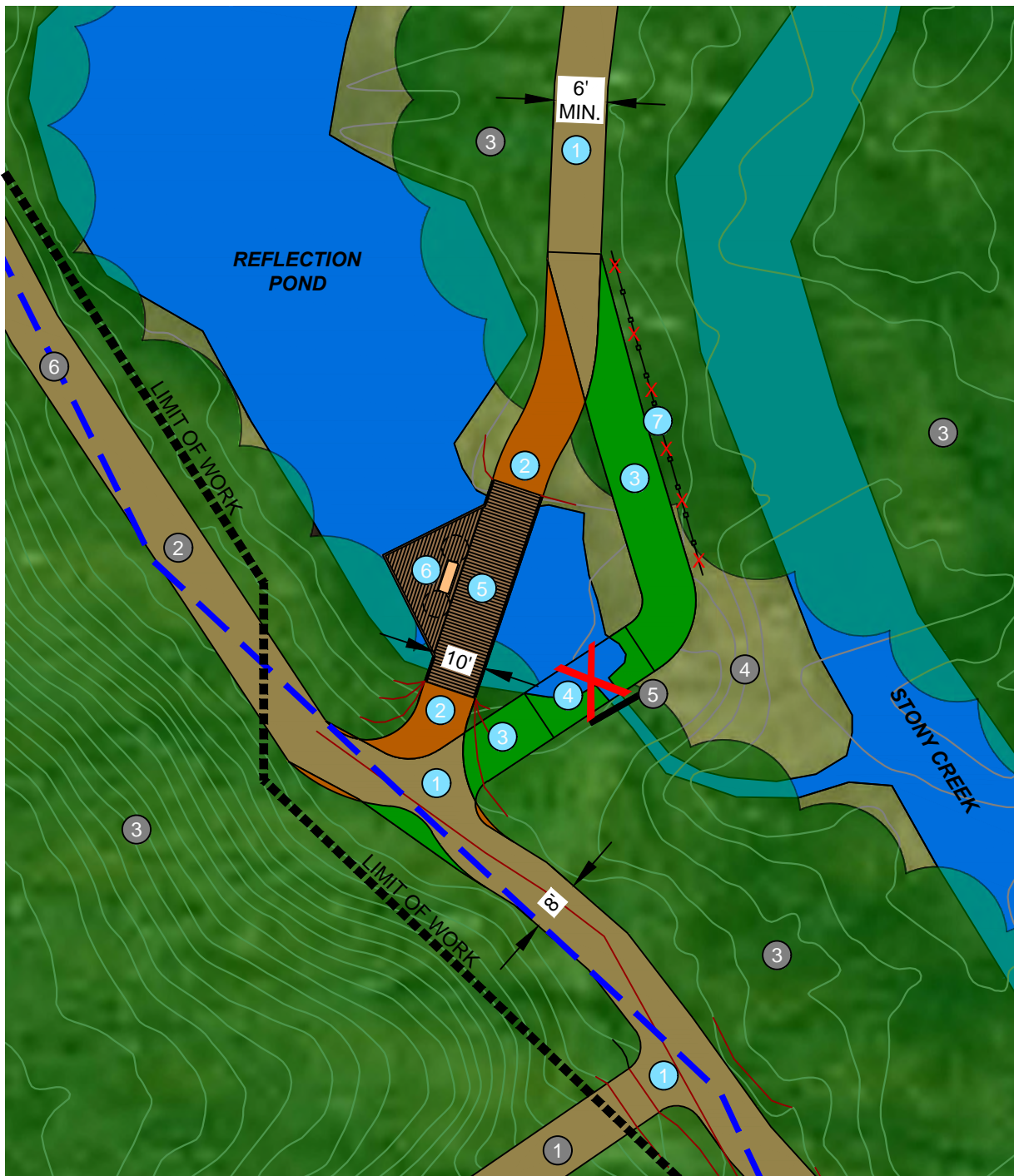

**EXISTING CONDITION NOTES**

- 1 NATURE TRAIL TO REMAIN AS IS
- 2 GATED SERVICE PATH TO REMAIN AS IS
- 3 FOREST
- 4 NO MOW AREA
- 5 SMALL DAM
- 6 APPROX. EDGE OF FLOODPLAIN

**PROPOSED WORK**

- 1 ADJUST GRADE OF EXISTING AGGREGATE PATHS. THE 6' & 8' WIDE UA 21AA AGGREGATE PATHS WITH LIMESTONE FINES SHALL NOT EXCEED 5% RUNNING SLOPE & 2% CROSS PITCH.
- 2 REALIGN THE EXISTING TRAIL. THE UA PATH SHALL BE 6' MIN. WIDTH & CONSTRUCTED OF 21AA AGGREGATE WITH LIMESTONE FINES. TRANSITION ON TO POND DIPPING PLATFORM SHALL NOT EXCEED 1/2".
- 3 REMOVE EXISTING AGGREGATE PATH & RESTORE WITH TOPSOIL, SEED, & MATERIALS FOUND ON THE FOREST FLOOR.
- 4 REMOVE EXISTING BRIDGE #2
- 5 625 SF POND DIPPING PLATFORM & BRIDGE STRUCTURE. THE BRIDGE PORTION OF THE STRUCTURE SHALL BE 10' WIDE TO ALLOW GATOR TRAFFIC FOR TRAIL MAINTENANCE. THE PERIMETER OF THE POND DIPPING STRUCTURE SHALL HAVE A WHEELCHAIR GUARD (NO RAILING). RAILINGS TO BE ADDED ALONG THE ENTIRE SOUTH SIDE OF THE BRIDGE PORTION & AT THE ENTRY ON & OFF OF THE BRIDGE PORTION OF THE STRUCTURE.
- 6 SURFACE MOUNTED 6' BENCH WITH WHEELCHAIR SPACE ON EACH SIDE
- 7 EXISTING SPLIT RAIL FENCE TO BE REMOVED ALONG SECTION OF TRAIL TO BE ELIMINATED.

**POND DIPPING PLATFORM / BRIDGE #2 ENLARGEMENT**

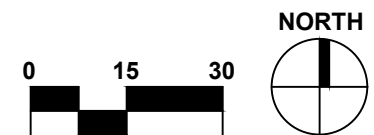



**EXISTING CONDITION NOTES**

- ① NATURE TRAIL
- ② FOREST
- ③ NO MOW AREA
- ④ SMALL DAM
- ⑤ APPROX. EDGE OF FLOODPLAIN

**PROPOSED WORK**

- ① ADJUST GRADE OF EXISTING AGGREGATE PATHS. THE 6' & 8' WIDE UA 21AA AGGREGATE PATHS WITH LIMESTONE FINES SHALL NOT EXCEED 5% RUNNING SLOPE & 2% CROSS PITCH.
- ② TRANSITIONS ON TO BRIDGE #3 SHALL NOT EXCEED 1/2".
- ③ REPLACE EXISTING BRIDGE #3 WITH A PREFABRICATED BRIDGE WITH RAILINGS
- ④ RELOCATE EXISTING BENCH TO AN ACCESSIBLE LOCATION WITH A WHEELCHAIR SPACE TO ONE SIDE OF THE BENCH. THERE ARE FOUR BENCHES NOT SHOWN IN ANY OF THE ENLARGEMENTS THAT WILL BE RELOCATED TO ACCESSIBLE LOCATIONS SIMILAR TO THIS. THESE FOUR BENCHES ARE IDENTIFIED ON THE EXISTING CONDITIONS PLAN.
- ⑤ INSTALL 21AA AGGREGATE WITH LIMESTONE FINES TO CREATE AN ACCESSIBLE SEATING AREA ALONG THE TRAIL WITH SLOPES LESS THAN 2%.

**BRIDGE #3 ENLARGEMENT**

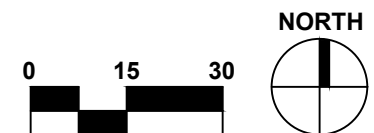



**EXISTING CONDITION NOTES**

- ① FOREST
- ② APPROX. EDGE OF FLOODPLAIN

**PROPOSED WORK**

- ① ADJUST GRADE & ALIGNMENT OF THE EXISTING AGGREGATE NATURE TRAIL AS NEEDED. THE 6' & 8' WIDE UA 21AA AGGREGATE PATHS WITH LIMESTONE FINES SHALL NOT EXCEED 5% RUNNING SLOPE & 2% CROSS PITCH.
- ② TRANSITIONS ON TO BRIDGE #3 SHALL NOT EXCEED 1/2".
- ③ REPLACE EXISTING BRIDGE #3 WITH A PREFABRICATED BRIDGE WITH RAILINGS
- ④ RELOCATE EXISTING BENCH TO AN ACCESSIBLE LOCATION WITH A WHEELCHAIR SPACE TO ONE SIDE OF THE BENCH.
- ⑤ INSTALL 21AA AGGREGATE WITH LIMESTONE FINES TO CREATE AN ACCESSIBLE SEATING AREA ALONG THE TRAIL WITH SLOPES LESS THAN 2%.

ALL AGGREGATE TRAIL SECTIONS WITHIN THE LIMIT OF WORK ALONG THE REFLECTION TRAIL LOOP WILL BE MODIFIED AS NEEDED TO MEET UA TRAIL STANDARDS.

THE TRAIL WIDTH SHALL BE 6' MIN. WIDTH. RUNNING SLOPES SHALL NOT EXCEED 5% & CROSS SLOPES SHALL NOT EXCEED 2%.

THE ENLARGEMENTS PROVIDED ILLUSTRATE SOME OF THE WORST SECTIONS ALONG THE TRAIL NEEDING THE MOST WORK.

A DETAILED SURVEY WILL BE COMPLETED TO VERIFY COMPLIANCE OR NON-COMPLIANCE OF THE EXISTING TRAIL LOOP.

**TYPICAL TRAIL IMPROVEMENTS**

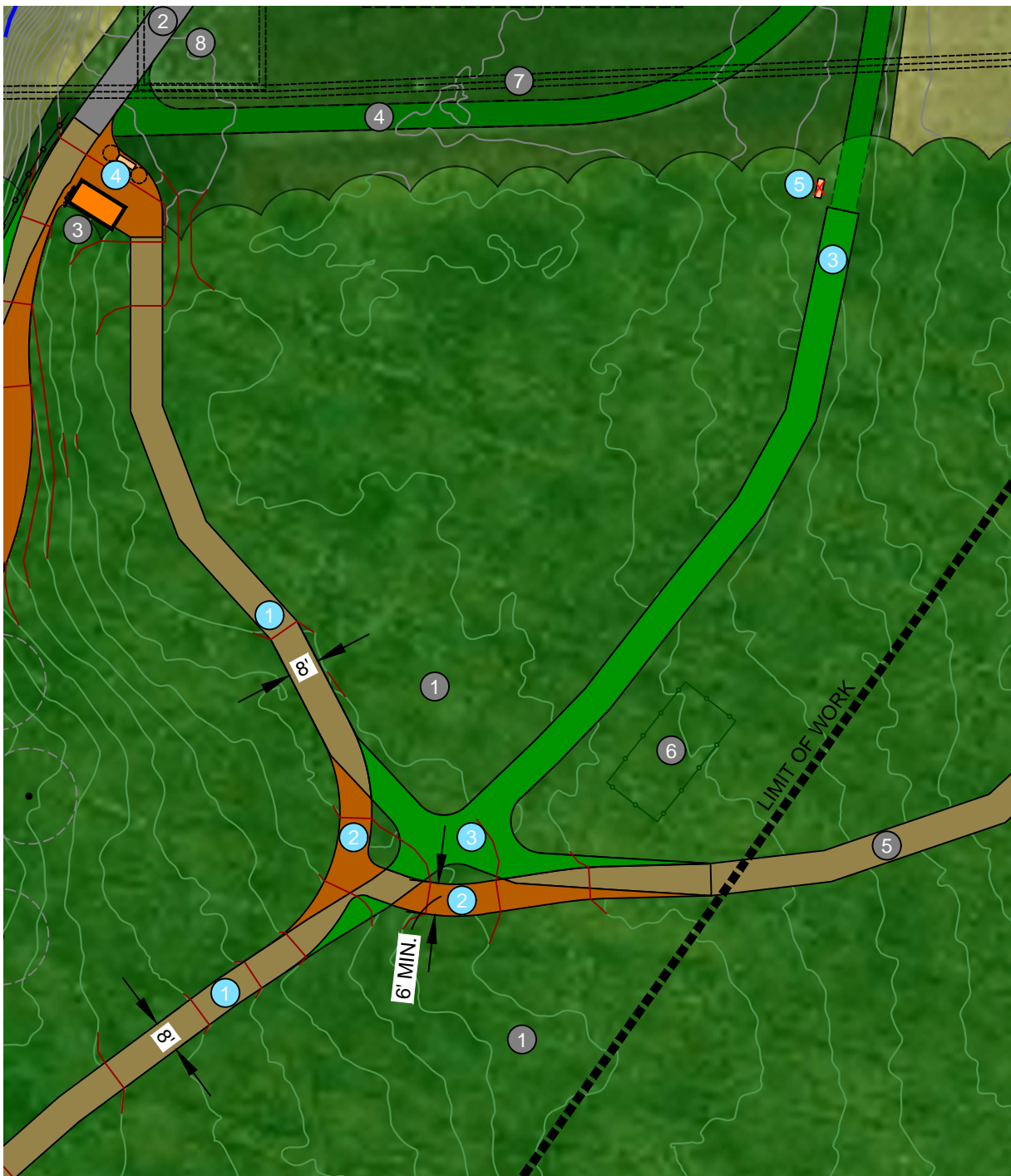

**EXISTING CONDITION NOTES**

- ① FOREST
- ② ASPHALT PATH
- ③ TRAILHEAD STRUCTURE
- ④ OLD TRAIL RECENTLY RESTORED WITH TURF
- ⑤ ALTERNATE PATH BACK TO PARKING LOT TO REMAIN UNCHANGED
- ⑥ APPROXIMATE LOCATION OF FENCED DEER ENCLOSURE TO REMAIN
- ⑦ POWER LINES
- ⑧ POWER LINE TOWER

**PROPOSED WORK**

- ① ADJUST GRADE OF THE EXISTING AGGREGATE NATURE TRAIL AS NEEDED. THE 6' & 8' WIDE UA 21AA AGGREGATE PATHS WITH LIMESTONE FINES SHALL NOT EXCEED 5% RUNNING SLOPE & 2% CROSS PITCH.
- ② REALIGN THE EXISTING TRAIL. THE UA PATH SHALL BE 6' MIN. WIDTH & CONSTRUCTED OF 21AA AGGREGATE WITH LIMESTONE FINES.
- ③ EXISTING NATURE TRAIL TO BE RESTORED WITH SEED & NATURAL MATERIAL FOUND ON THE FOREST FLOOR. TRAIL IS BEING REMOVED TO CREATE A LOOP THAT BEGINS & ENDS AT THE EXISTING TRAILHEAD STRUCTURE.
- ④ PLACE 21AA AGGREGATE WITH FINES AT TRAILHEAD. REGRADE FOR UA WITH SLOPES NO GREATER THAN 2% IN BOTH DIRECTIONS IN FRONT OF EXISTING SIGN.
- ⑤ EXISTING BENCH TO BE RELOCATED TO AN ACCESSIBLE LOCATION NEAR THE EXISTING TRAILHEAD.

**TRAIL ALIGNMENT CHANGE ENLARGEMENT**

**Stony Creek Metropark - LW22-0003 Reflection Trail Improvements**

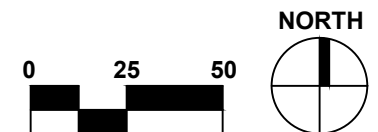

**January 2022**

**8 OF 9**



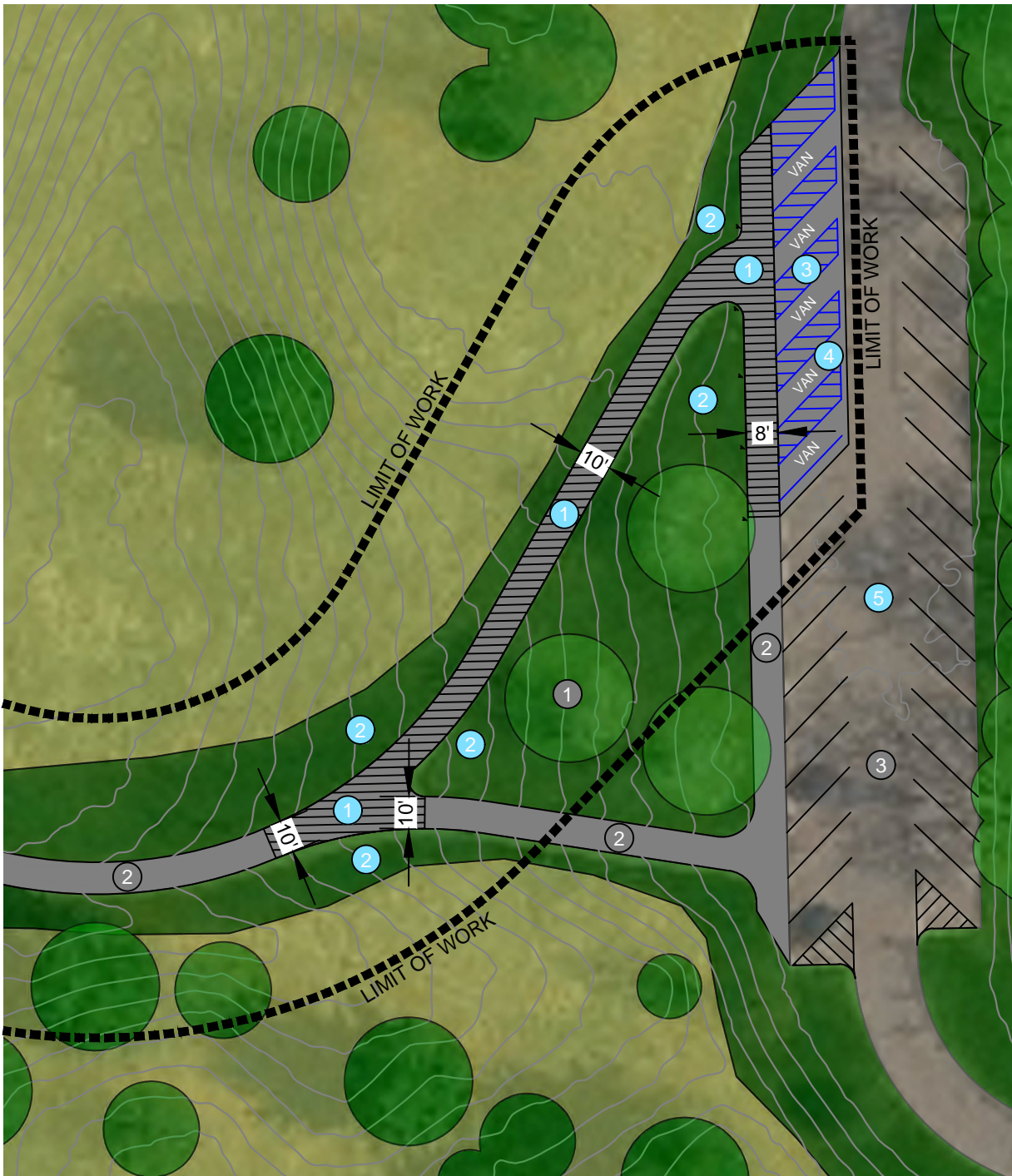

**EXISTING CONDITION NOTES**

- ① SHADE TREES
- ② ASPHALT PATH
- ③ PARKING LOT

**PROPOSED WORK**

- ① UA ASPHALT WALK. REPLACE EXISTING ASPHALT WALK THAT IS NOT ADA COMPLIANT. EXISTING CROSS SLOPES EXCEED 4% IN MANY LOCATIONS WITH RUNNING SLOPES EXCEEDING 6% IN A COUPLE OF SPOTS.
- ② SITE GRADING AND TURF RESTORATION AS NEEDED TO CORRECT WALKWAY SLOPE ISSUES
- ③ UA ACCESSIBLE VAN PARKING LOT STRIPING, 5 TOTAL (4 REQUIRED). EACH ANGLED PARKING SPACE IS REQUIRED TO HAVE A STRIPED AISLE BY ADA.
- ④ NEW ASPHALT PAVEMENT WITHIN PARKING LOT TO FIX PAVEMENT CRACKING & SLOPE ISSUES AT ACCESSIBLE PARKING SPACES
- ⑤ PARKING LOT SPACE TOTALS WILL BE REDUCED FROM 78 TO 76 AFTER THE RESTRIPING OF THE ACCESSIBLE PARKING AREA

**ACCESS WALK ENLARGEMENT**