

RAPIDS VIEW DEVELOPMENT

HUDSON MILLS METROPARK

FEBRUARY 12, 2019

EXISTING CONDITIONS PLAN

TF19-0012

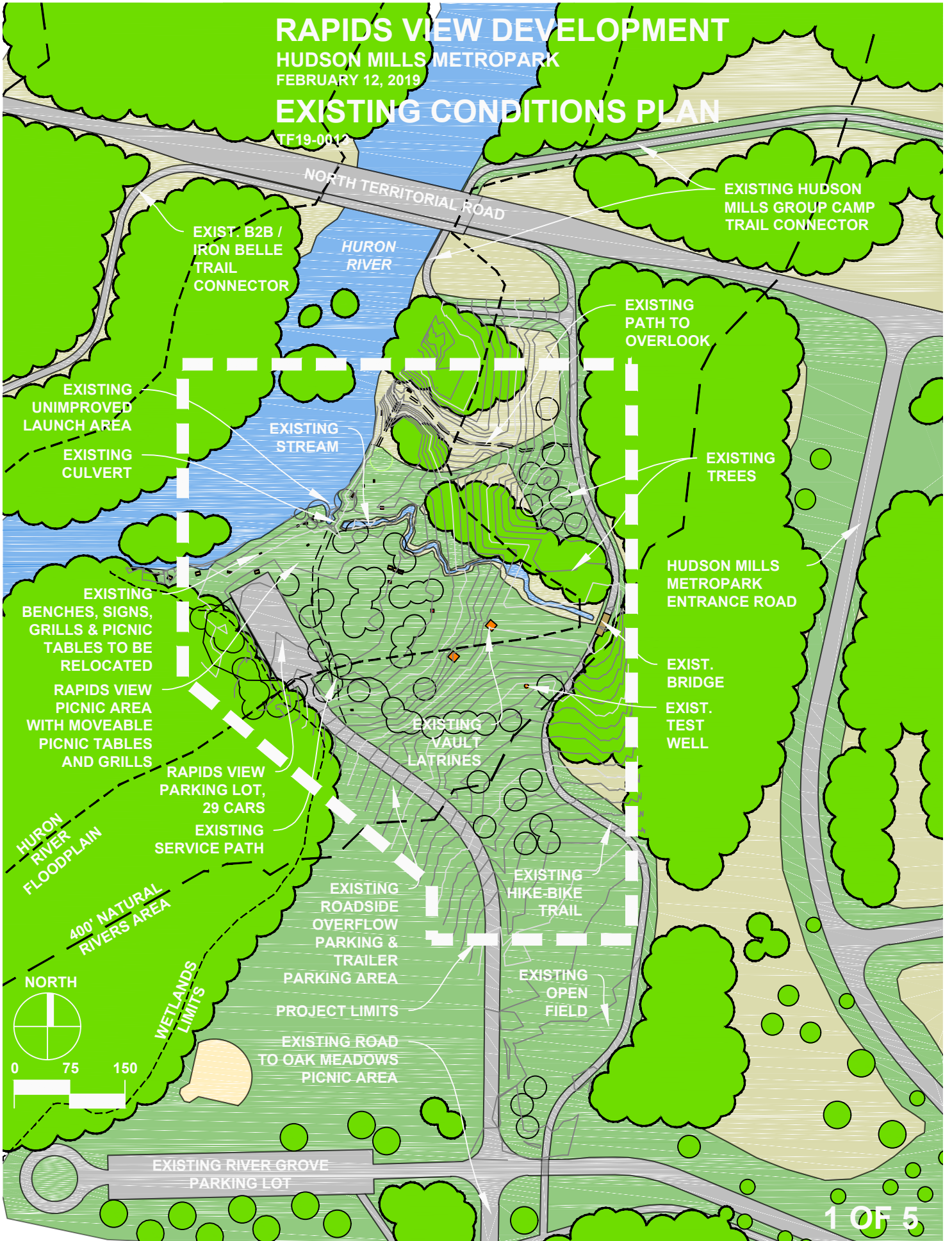

EXISTING HUDSON MILLS GROUP CAMP TRAIL CONNECTOR

EXIST. B2B / IRON BELLE TRAIL CONNECTOR

EXISTING PATH TO OVERLOOK

EXISTING TREES

HUDSON MILLS METROPARK ENTRANCE ROAD

EXIST. BRIDGE
EXIST. TEST WELL

EXISTING VAULT LATRINES

EXISTING HIKE-BIKE TRAIL

EXISTING OPEN FIELD

EXISTING ROADSIDE OVERFLOW PARKING & TRAILER PARKING AREA

PROJECT LIMITS
EXISTING ROAD TO OAK MEADOWS PICNIC AREA

RAPIDS VIEW PARKING LOT, 29 CARS
EXISTING SERVICE PATH

EXISTING BENCHES, SIGNS, GRILLS & PICNIC TABLES TO BE RELOCATED
RAPIDS VIEW PICNIC AREA WITH MOVEABLE PICNIC TABLES AND GRILLS

EXISTING UNIMPROVED LAUNCH AREA
EXISTING CULVERT

EXISTING STREAM

NORTH TERRITORIAL ROAD

HURON RIVER

HURON RIVER FLOODPLAIN

400' NATURAL RIVERS AREA

WETLANDS LIMITS

NORTH

0 75 150

EXISTING RIVER GROVE PARKING LOT

RAPIDS VIEW DEVELOPMENT

HUDSON MILLS METROPARK

FEBRUARY 12, 2019

PROPOSED CONCEPT PLAN

TF19-0012

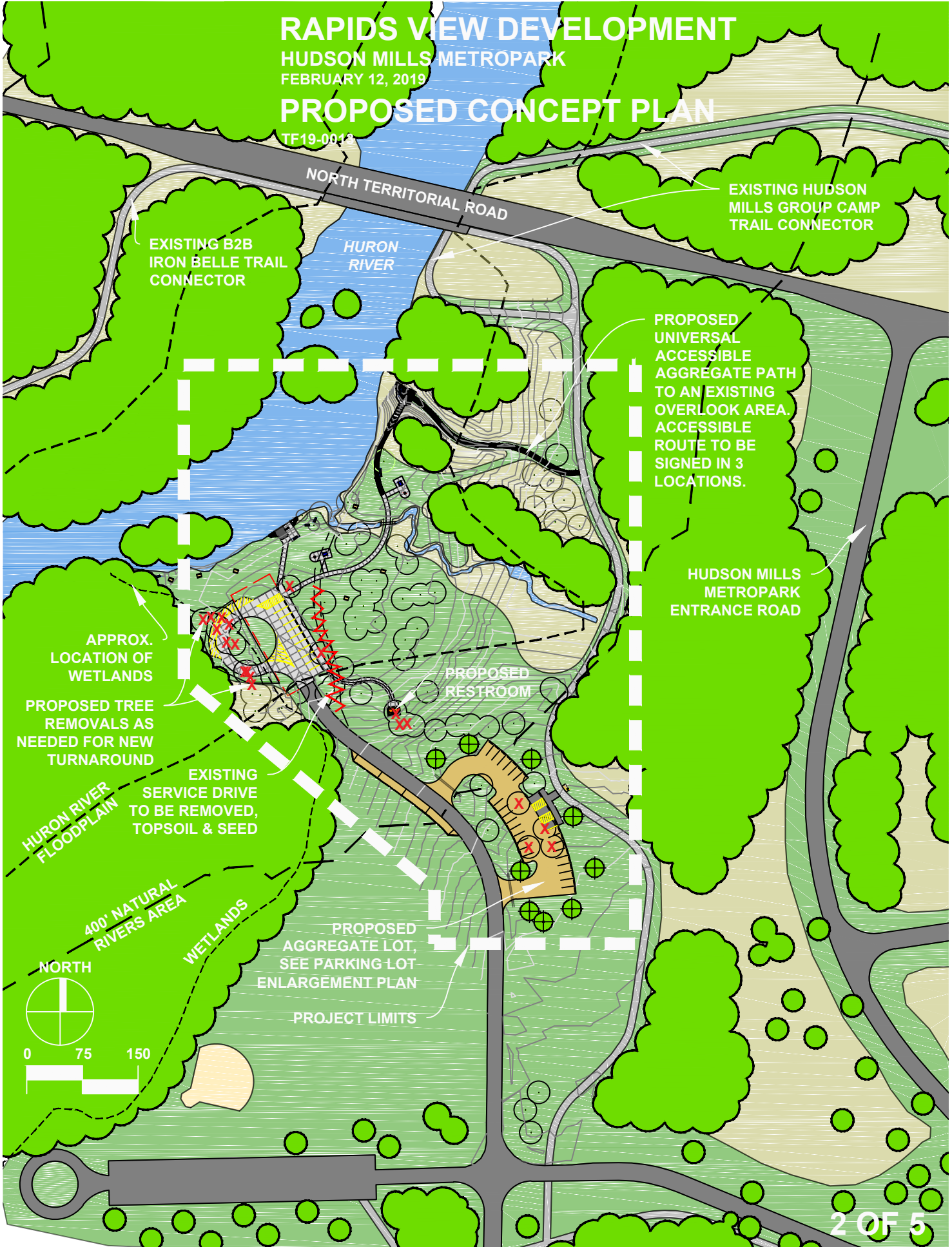

EXISTING B2B
IRON BELLE TRAIL
CONNECTOR

HURON
RIVER

NORTH TERRITORIAL ROAD

EXISTING HUDSON
MILLS GROUP CAMP
TRAIL CONNECTOR

PROPOSED
UNIVERSAL
ACCESSIBLE
AGGREGATE PATH
TO AN EXISTING
OVERLOOK AREA.
ACCESSIBLE
ROUTE TO BE
SIGNED IN 3
LOCATIONS.

HUDSON MILLS
METROPARK
ENTRANCE ROAD

APPROX.
LOCATION OF
WETLANDS

PROPOSED TREE
REMOVALS AS
NEEDED FOR NEW
TURNAROUND

PROPOSED
RESTROOM

HURON RIVER
FLOODPLAIN

EXISTING
SERVICE DRIVE
TO BE REMOVED,
TOPSOIL & SEED

400' NATURAL
RIVERS AREA

WETLANDS

PROPOSED
AGGREGATE LOT,
SEE PARKING LOT
ENLARGEMENT PLAN

PROJECT LIMITS

NORTH

0 75 150

RAPIDS VIEW DEVELOPMENT

HUDSON MILLS METROPARK

FEBRUARY 12, 2019

ENLARGEMENT PLAN

TF19-0013

NOTE:
INDIVIDUAL TREE CANOPIES
ARE NOT SHOWN ON PARTS
OF THIS PLAN IN ORDER TO
SHOW AND LABEL PROJECT
DETAIL

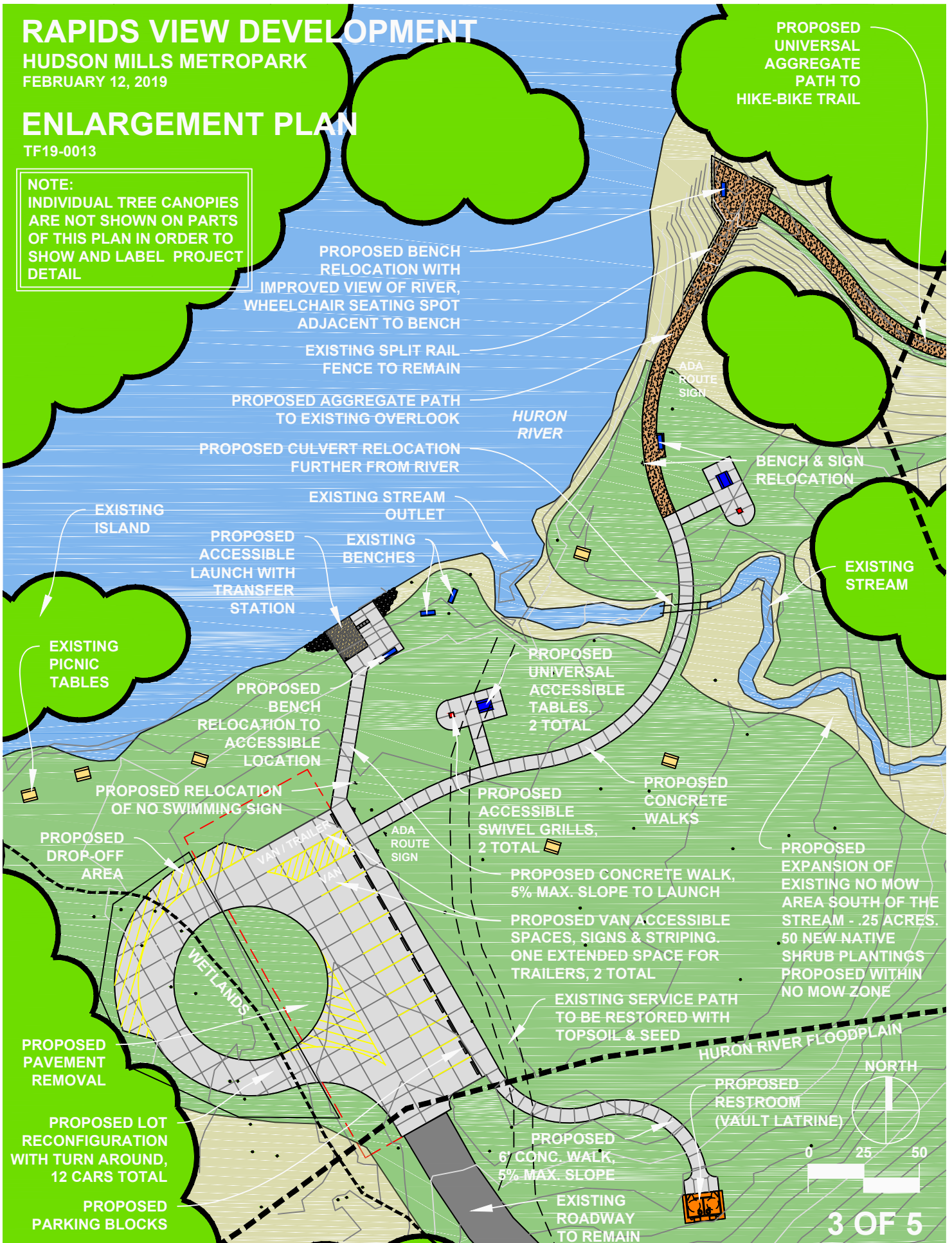

PROPOSED
UNIVERSAL
AGGREGATE
PATH TO
HIKE-BIKE TRAIL

PROPOSED BENCH
RELOCATION WITH
IMPROVED VIEW OF RIVER,
WHEELCHAIR SEATING SPOT
ADJACENT TO BENCH

EXISTING SPLIT RAIL
FENCE TO REMAIN

PROPOSED AGGREGATE PATH
TO EXISTING OVERLOOK

PROPOSED CULVERT RELOCATION
FURTHER FROM RIVER

EXISTING STREAM
OUTLET

PROPOSED
ACCESSIBLE
LAUNCH WITH
TRANSFER
STATION

EXISTING
BENCHES

ADA
ROUTE
SIGN

BENCH & SIGN
RELOCATION

EXISTING
STREAM

EXISTING
ISLAND

EXISTING
PICNIC
TABLES

PROPOSED
BENCH
RELOCATION TO
ACCESSIBLE
LOCATION

PROPOSED
UNIVERSAL
ACCESSIBLE
TABLES,
2 TOTAL

PROPOSED RELOCATION
OF NO SWIMMING SIGN

PROPOSED
ACCESSIBLE
SWIVEL GRILLS,
2 TOTAL

PROPOSED
CONCRETE
WALKS

PROPOSED
DROP-OFF
AREA

VAN / TRAILER
VAN

ADA
ROUTE
SIGN

PROPOSED CONCRETE WALK,
5% MAX. SLOPE TO LAUNCH

PROPOSED VAN ACCESSIBLE
SPACES, SIGNS & STRIPING.
ONE EXTENDED SPACE FOR
TRAILERS, 2 TOTAL

PROPOSED
EXPANSION OF
EXISTING NO MOW
AREA SOUTH OF THE
STREAM - 25 ACRES.
50 NEW NATIVE
SHRUB PLANTINGS
PROPOSED WITHIN
NO MOW ZONE

PROPOSED
PAVEMENT
REMOVAL

PROPOSED LOT
RECONFIGURATION
WITH TURN AROUND,
12 CARS TOTAL

PROPOSED
PARKING BLOCKS

EXISTING SERVICE PATH
TO BE RESTORED WITH
TOPSOIL & SEED

HURON RIVER FLOODPLAIN

PROPOSED
RESTROOM
(VAULT LATRINE)

PROPOSED
6' CONC. WALK,
5% MAX. SLOPE

EXISTING
ROADWAY
TO REMAIN

NORTH

0 25 50

3 OF 5

RAPIDS VIEW DEVELOPMENT

HUDSON MILLS METROPARK

FEBRUARY 12, 2019

LAUNCH ENLARGEMENT

TF19-0013

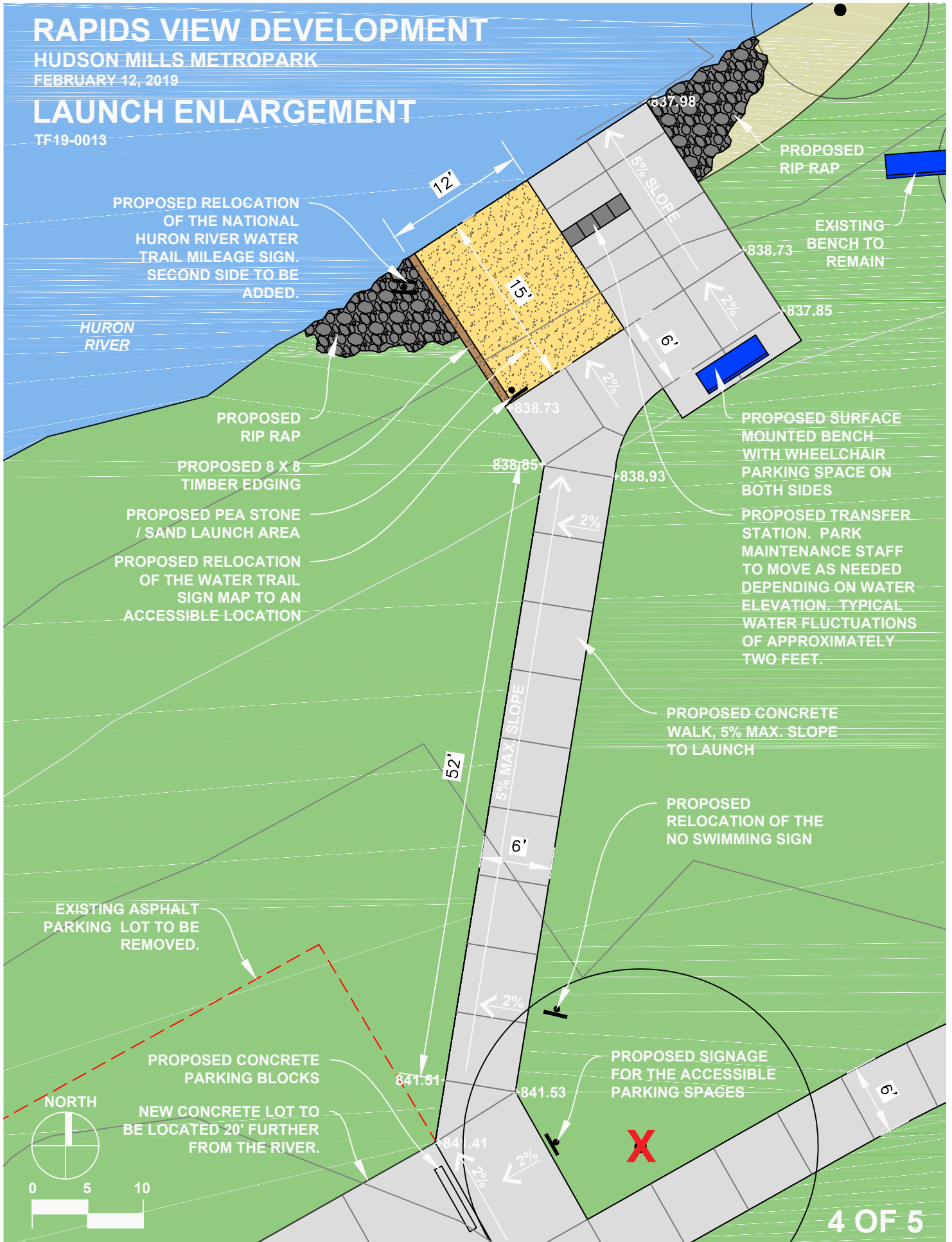

RAPIDS VIEW DEVELOPMENT

HUDSON MILLS METROPARK

FEBRUARY 12, 2019

UPPER PARKING LOT ENLARGEMENT

TF19-0013

