

# WEST BOAT LAUNCH AREA DEVELOPMENT

KENSINGTON METROPARK  
FEBRUARY 12, 2019

## EXISTING CONDITIONS PLAN

TF19-0049

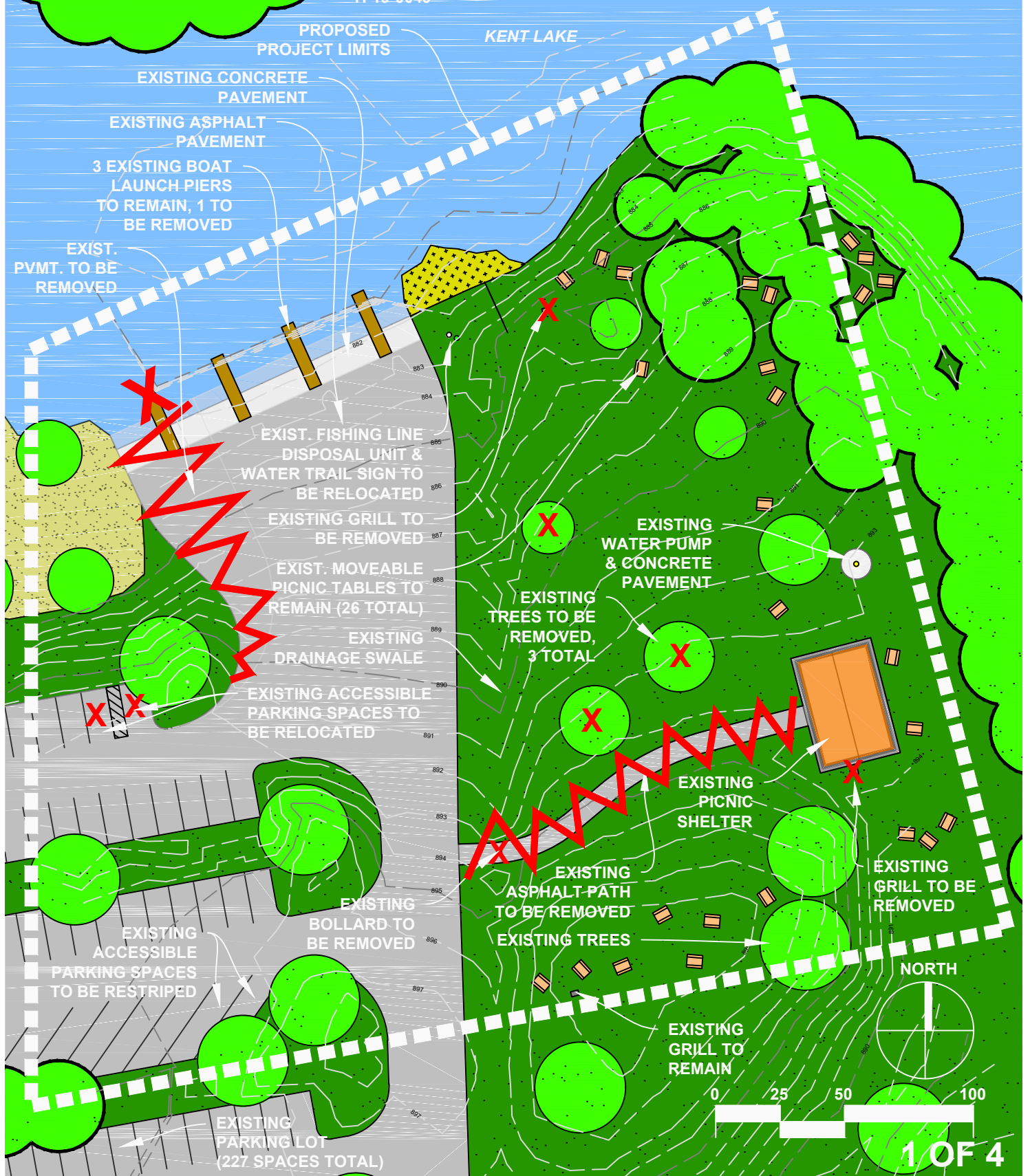

# WEST BOAT LAUNCH AREA DEVELOPMENT

## KENSINGTON METROPARK

FEBRUARY 12, 2019

# PROPOSED CONCEPT PLAN

TF19-0049

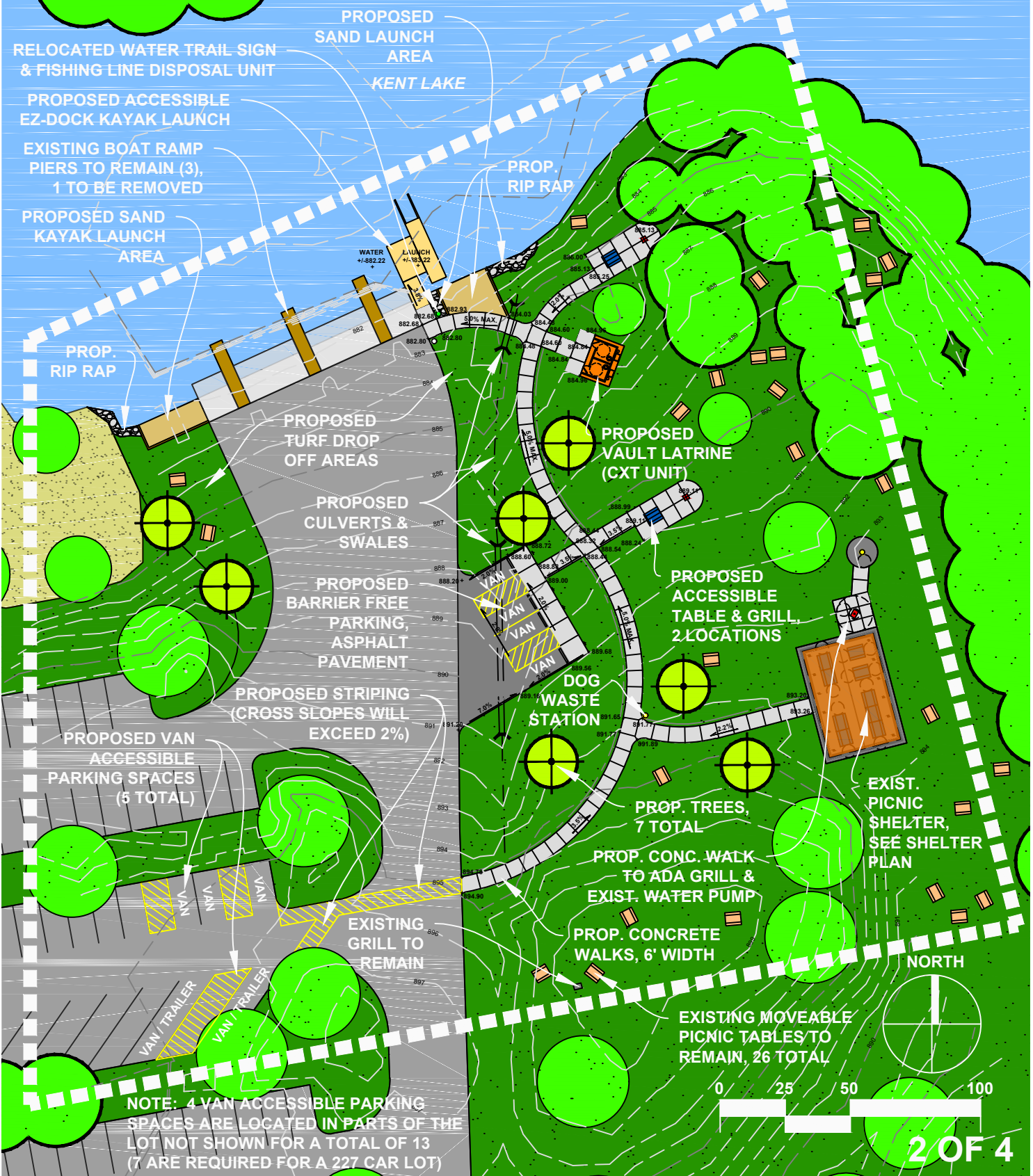

NOTE: 4 VAN ACCESSIBLE PARKING SPACES ARE LOCATED IN PARTS OF THE LOT NOT SHOWN FOR A TOTAL OF 13 (7 ARE REQUIRED FOR A 227 CAR LOT)

# WEST BOAT LAUNCH AREA DEVELOPMENT ENLARGEMENT PLAN

TF19-0049

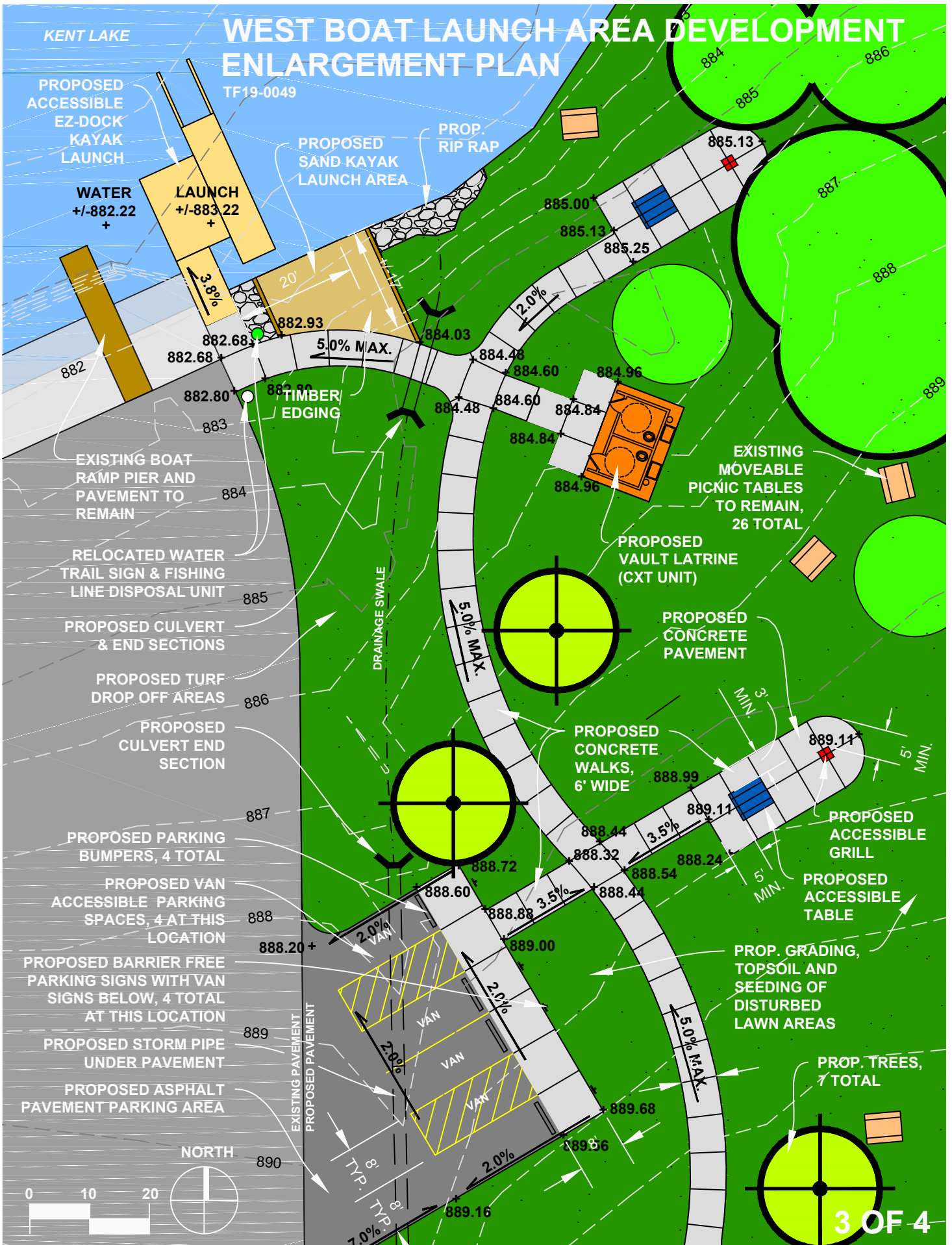

# WEST BOAT LAUNCH AREA DEVELOPMENT

KENSINGTON METROPARK

FEBRUARY 12, 2019

## SHELTER ENLARGEMENT PLAN PLAN

TF19-0049

NORTH

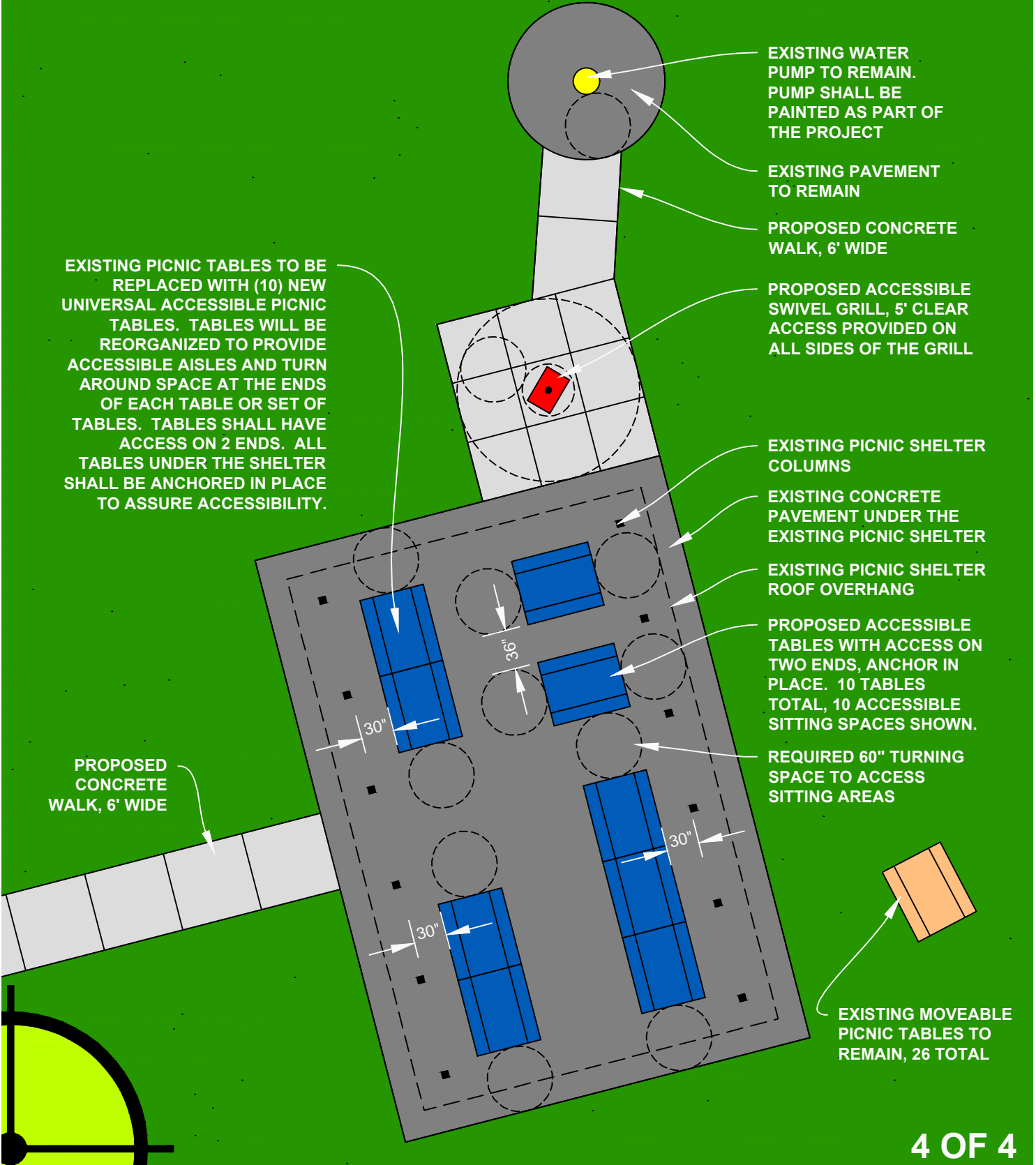

EXISTING WATER PUMP TO REMAIN. PUMP SHALL BE PAINTED AS PART OF THE PROJECT

EXISTING PAVEMENT TO REMAIN

PROPOSED CONCRETE WALK, 6' WIDE

PROPOSED ACCESSIBLE SWIVEL GRILL, 5' CLEAR ACCESS PROVIDED ON ALL SIDES OF THE GRILL

EXISTING PICNIC SHELTER COLUMNS

EXISTING CONCRETE PAVEMENT UNDER THE EXISTING PICNIC SHELTER

EXISTING PICNIC SHELTER ROOF OVERHANG

PROPOSED ACCESSIBLE TABLES WITH ACCESS ON TWO ENDS, ANCHOR IN PLACE. 10 TABLES TOTAL, 10 ACCESSIBLE SITTING SPACES SHOWN.

REQUIRED 60" TURNING SPACE TO ACCESS SITTING AREAS

EXISTING MOVEABLE PICNIC TABLES TO REMAIN, 26 TOTAL

EXISTING PICNIC TABLES TO BE REPLACED WITH (10) NEW UNIVERSAL ACCESSIBLE PICNIC TABLES. TABLES WILL BE REORGANIZED TO PROVIDE ACCESSIBLE AISLES AND TURN AROUND SPACE AT THE ENDS OF EACH TABLE OR SET OF TABLES. TABLES SHALL HAVE ACCESS ON 2 ENDS. ALL TABLES UNDER THE SHELTER SHALL BE ANCHORED IN PLACE TO ASSURE ACCESSIBILITY.

PROPOSED CONCRETE WALK, 6' WIDE

30"

36"

30"

30"