

TRAIL INTERSECTIONS

-
- Left Method:**
- 1" SPACE BETWEEN MAP AND PLASTIC SIGN PANELS
 - SIGN PANEL, DRILL HOLES AND ATTACH WITH GALVANIZED SCREWS TOP AND BOTTOM
 - 12 X 18 MAP
 - 1" SPACE BETWEEN MAP AND PLASTIC SIGN PANELS
 - 1/2" SPACE BETWEEN GROUPINGS OF PLASTIC SIGN PANELS
 - 3' X 3' X 1/4" THICK PLASTIC PANELS. HOLES TO BE DRILLED BY PARK STAFF. ATTACH WITH 1" BROWN HEADED SCREWS
 - 4 X 4 X 8' POST (4'-6" EXPOSED), BURY 3'-6" IN GROUND
 - INSTALL SOME FORM OF A DEADMAN AT BOTTOM OF POST TO PREVENT HEAVING AND REMOVAL. SPIKES, REBAR OR WOOD CROSS MEMBER
 - COMPACTED SUBGRADE
- Right Method:**
- CUT TOP OF POST (1") SLOPE AWAY FROM TRAILHEAD MAP

6"

1" SPACE BETWEEN MAP AND PLASTIC SIGN PANELS

2

12 X 18 MAP

SIGN PANEL, DRILL HOLES AND ATTACH WITH GALVANIZED SCREWS TOP AND BOTTOM

4' 6"

4 X 4 X 8' POST (4'-6" EXPOSED), BURY 3'-6" IN GROUND

3' 6"

2"

2

CUT TOP OF POST (1") SLOPE AWAY FROM TRAILHEAD MAP

INSTALL SOME FORM OF A DEADMAN AT BOTTOM OF POST TO PREVENT HEAVING AND REMOVAL. SPIKES, REBAR OR WOOD CROSS MEMBER

COMPACTED SUBGRADE

28

EQUESTRIAN TRAIL INTERSECTIONS

- Intersection signs shall be placed at all trail intersections and located a minimum of 3' from the edge of trail. The top of the post shall pitch away from the sign and trail.
- Signabond Lite 3mm Aluminum Composite Sign Panels with .75" radius corners shall be secured to an unstained 4 x 4 x 10' pressure treated sign post.
- Sign panels shall have a 2-sided, full color imprint, printed on permanent vinyl with luster lam. Back of sign shall be Dark Blue PMS 647C.
- "You are Here" symbols will be part of the graphic sign panel and will not be added after installation.
- The trail intersection number the user is at is indicated at the top of the post.
- An equestrian trail symbol shall appear just below the map.
- A no bikes symbol shall appear below the equestrian trail symbol.
- Nearby intersections, restrooms, and staging areas shall appear below no bikes with directional arrows.
- All four sides of the post can be used for wayfinding.
- Complex trail systems require additional directional signage below the map.

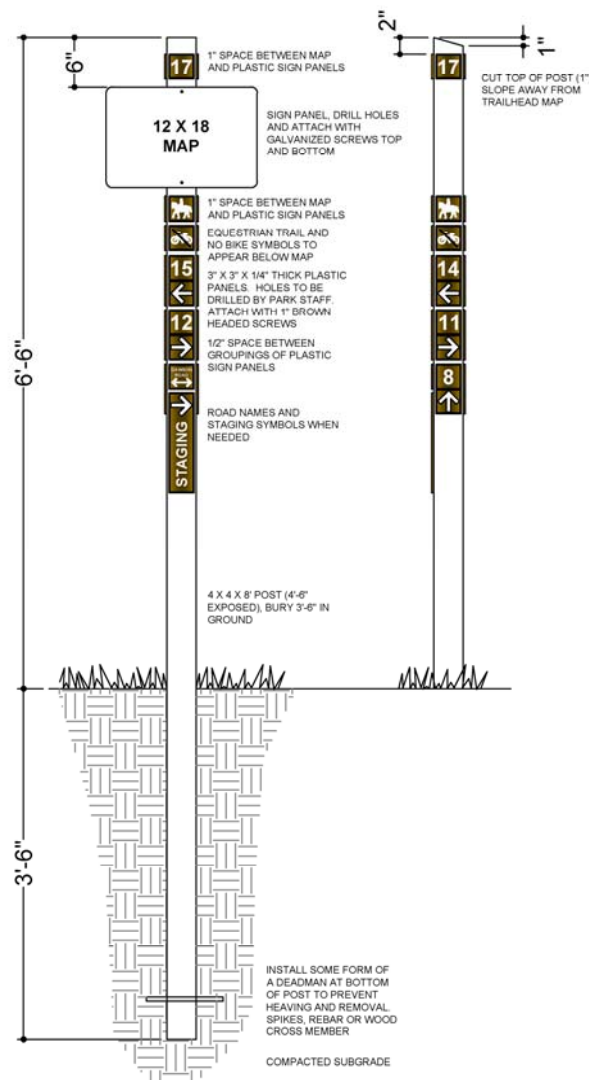

COMPLEX TRAIL SYSTEMS

PLASTIC SIGN ATTACHMENTS

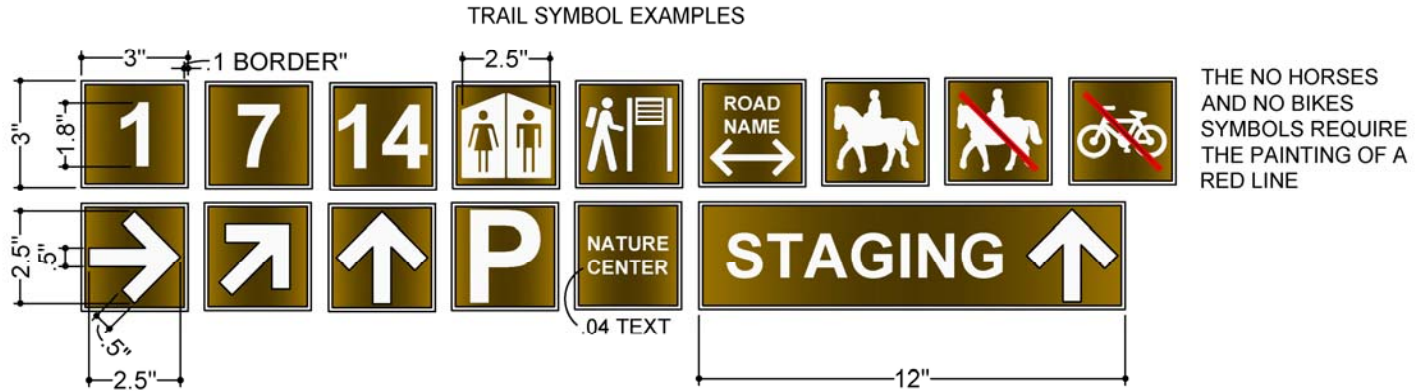

1/4" Plastic Sign Attachments

- Plastic sign symbols, 1/4" thick, shall be attached to an unstained 4 x 4 pressure treated sign post.
- Most trail posts require 8' length posts.
- Equestrian trails require longer 10' posts.
- Symbol placement should match the details shown on previous pages.

CONFIRMATION SIGNS

- Confirmation signs shall be placed on trail segments that exceed one-half mile in length and located a minimum of 3' from the edge of trail. The top of the post shall pitch away from the trail.
- The signs are intended to boost user confidence along lengthy trail segments.
- The upcoming intersection number and a directional arrow shall appear on both sides of the post.
- Trail maps are not required on confirmation signs.
- Pressure treated 4 x 4 posts for equestrian trail confirmation signs are 10' and shall remain unstained.

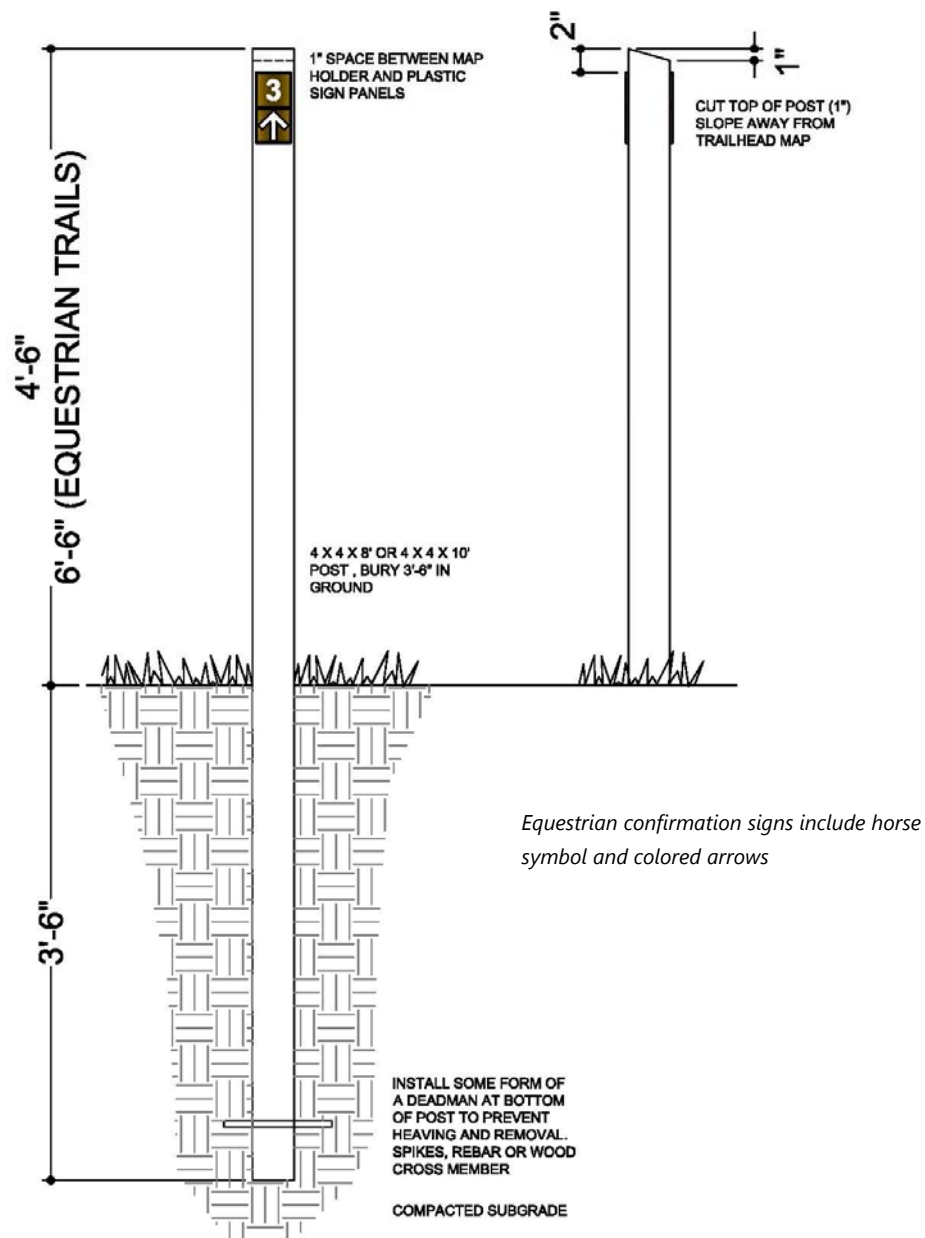

CONFIRMATION TRAIL SIGN

MILE MARKERS

Hike-Bike Trails: Mileage signs shall be located at intervals no greater than 1/2 mile, 3' minimum from the edge of pavement. Post length shall be 8'. Different colored signs shall be used for different trail segments.

Hike-Bike Trail Pavement Markings: Pavement markings shall appear at 1/4 mile intervals unless trail signage is installed at quarter mile intervals.

Equestrian Trails: Mileage signs shall be located at intervals no greater than 1 mile. Post length shall be 10'. All equestrian trail mileage markers shall be brown and white.

Mileage For Other Trail Types: Mileage will be shown on trail maps only, not on intersection or confirmation posts.

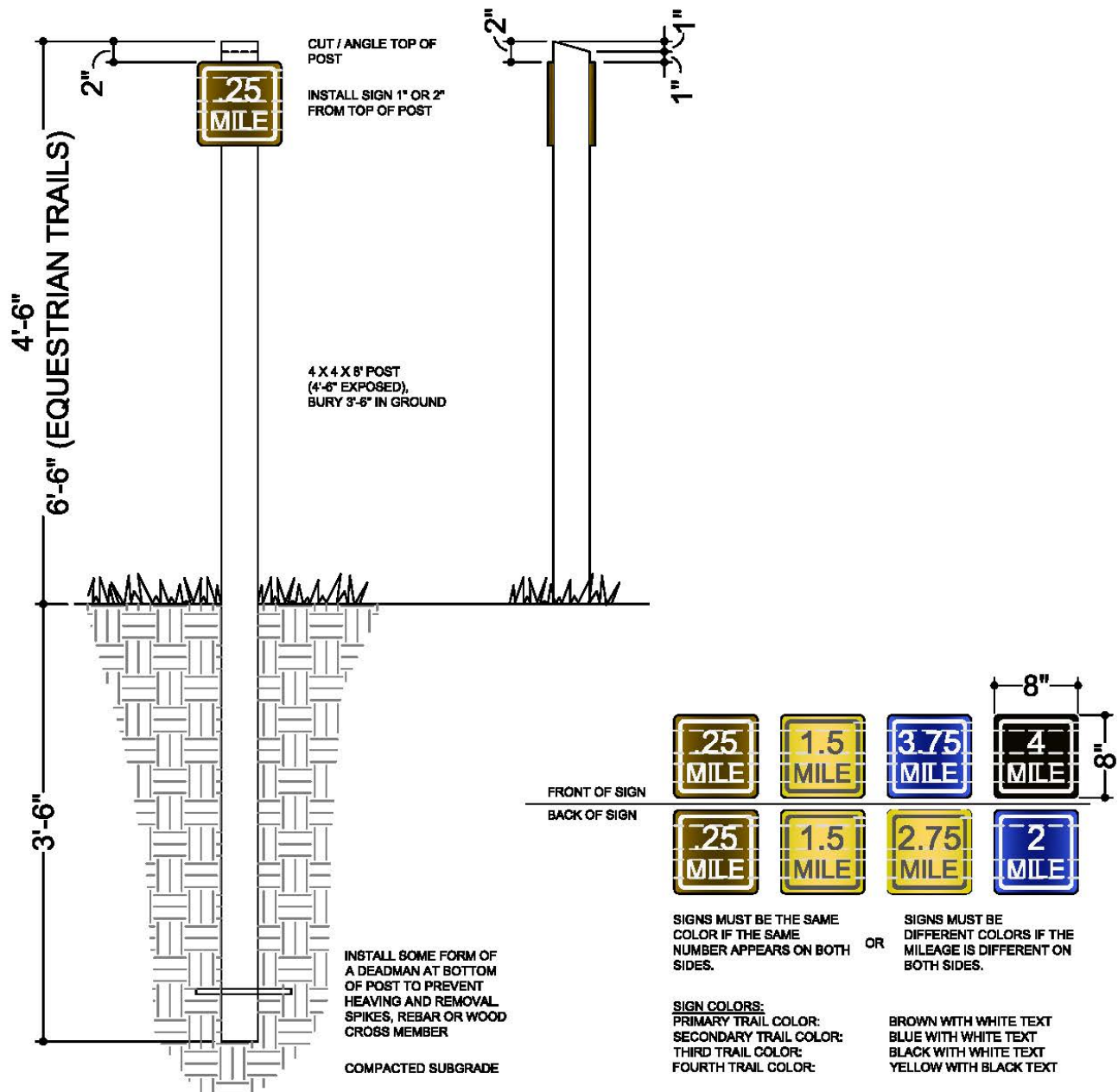

MAJOR TRAILHEADS

Purpose and Location

Trailheads provide an opportunity to orient visitors to a trail system and highlight the starting point for a trail or network of trails. Major trailheads shall be located in locations visible from a parking lot or entrance to an interpretive facility. The design of the trailhead structure is modeled after recently constructed wooden structures at Stony Creek Metropark.

Major Trailhead Design / Construction

- Structures shall be 10' wide x 8'-8" tall, single sided. Structures are to remain unstained.
- There shall be a minimum head clearance of 6'-10" below the roof of the structure.
- A 4' x 5'-6 1/2" sign board constructed of 3/4" plywood shall be installed between the structure posts. It shall be framed by 4" x 4" pressure treated lumber that has been rabbeted 3/4" deep. Add 2 x 4 furring strips to secure a 4' x 6' sign panel. Post spacing shall be a minimum of 72" to accept the Signabond Lite 3mm Aluminum Composite Panel with square corners.. Drill holes in sign as needed.
- A trail intersection identifier number shall be attached to the left sign post and aligned with the top 4 x 4 sign frame timber.
- Access to major trailhead structures shall meet ADA requirements even if the trails do not.
- A "You Are Here" marker shall appear on the graphics that are attached to the sign board.
- 3/4" x 8" Cedar Siding shall be used to fill in the back side of the sign panel and secured with nails.
- Material costs for the trailhead structure is approximately \$1,100

Optional Add-ons

- Bike repair station shall be manufactured by Dero Playcore Company, Model: Fixit Repair Station with Fixit Pump Air Kit 3 (with pressure gauge), Powder Coat Color: Sky Blue
- Custom Bike Rack shall be manufactured by Dero Playcore, Model: TBD, Color: TBD, Cost: TBD
- Donation plaques shall be centered above the sign panel on the 4 x 4 sign frame. Additional timbers shall be added to the top if necessary.
- Grant project identification plaques shall be centered similar to donation plaques.
- Boot scrapers shall be installed near the trailhead structures in locations that do not create a trip hazard.

Trailhead Structure Materials

(4) 6" X 6" X 12' P.T.
(3) 4" X 4" X 10' P.T.
(12) 4" X 4" X 8' P.T.
(4) 3/4" P.T. PLYWOOD (4' X 8')
DRIFTWOOD ARCH SHINGLES
(1) SQ PLUS (1) BUNDLE FOR RIDGE
(4) BAGS QUICKRETE
(20) 1/2" X 8" GALV LAG BOLTS
(36) 3/8" X 6" GALV LAG BOLTS
(8) 3/8" X 10" GALV CARRIAGE BOLTS
(20) 1/2" GALV FLAT WASHERS
(44) 3/8" GALV FLAT WASHERS
(8) 3/8" GALV HEX NUTS
(5) Lbs 2 1/2" GALV RING SHANK NAILS.

Sign Board Materials

(2) 4" x 4" x 12' P.T.
(1) 4' x 8' x 3/4" P.T. PLYWOOD
TIMBER SCREWS TO SECURE SIGN
BOARD TO STRUCTURE

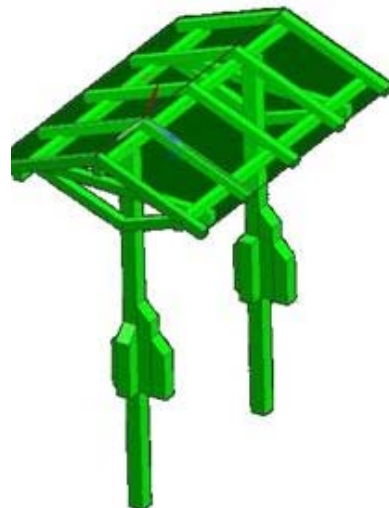

Trail Intersection Number Location (Typically Intersection #1)

Donation Plaque or Grant Plaque Location

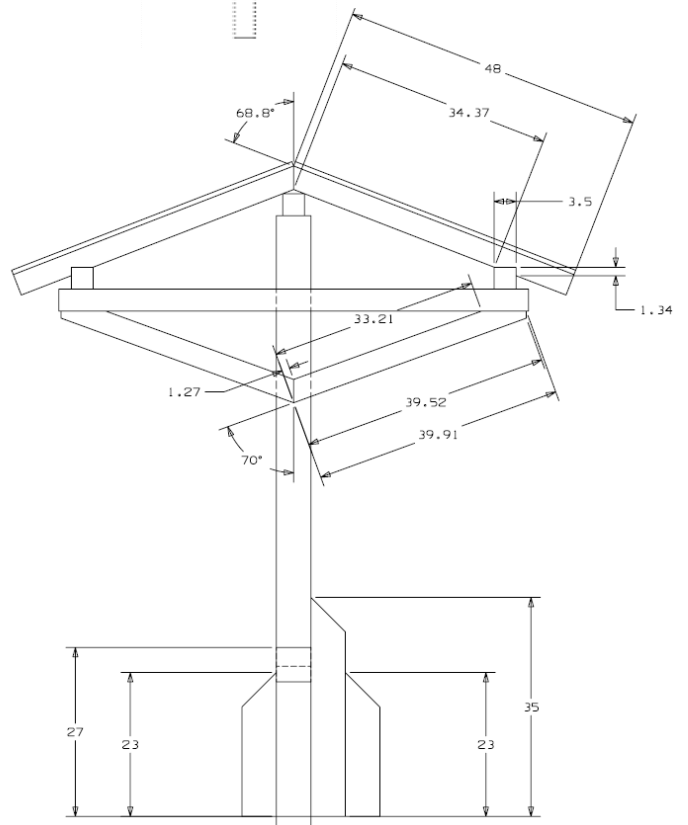
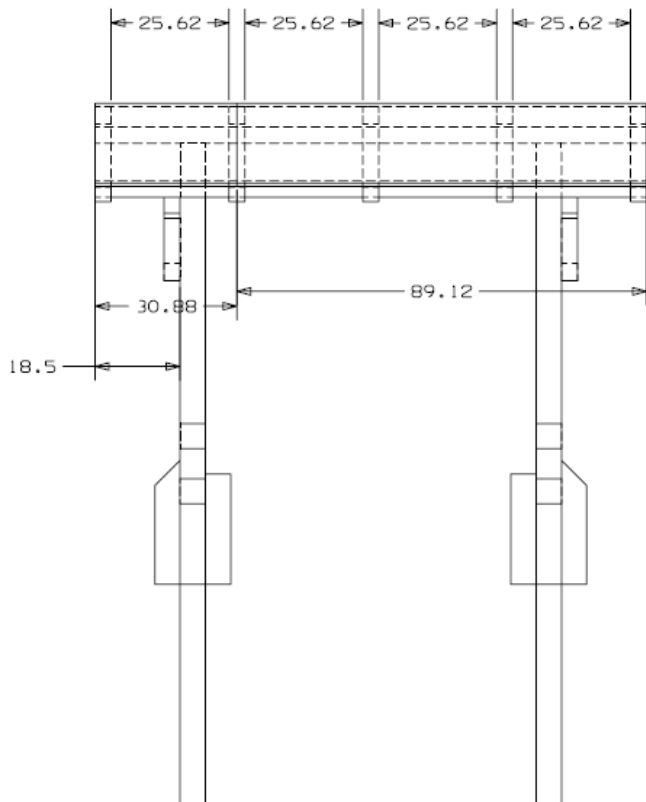
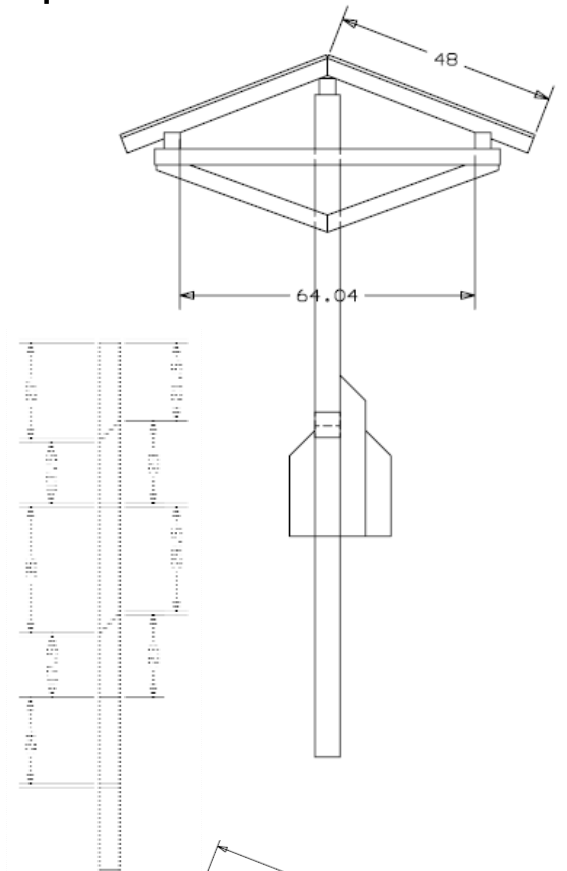

SIGN PANEL FRAMING

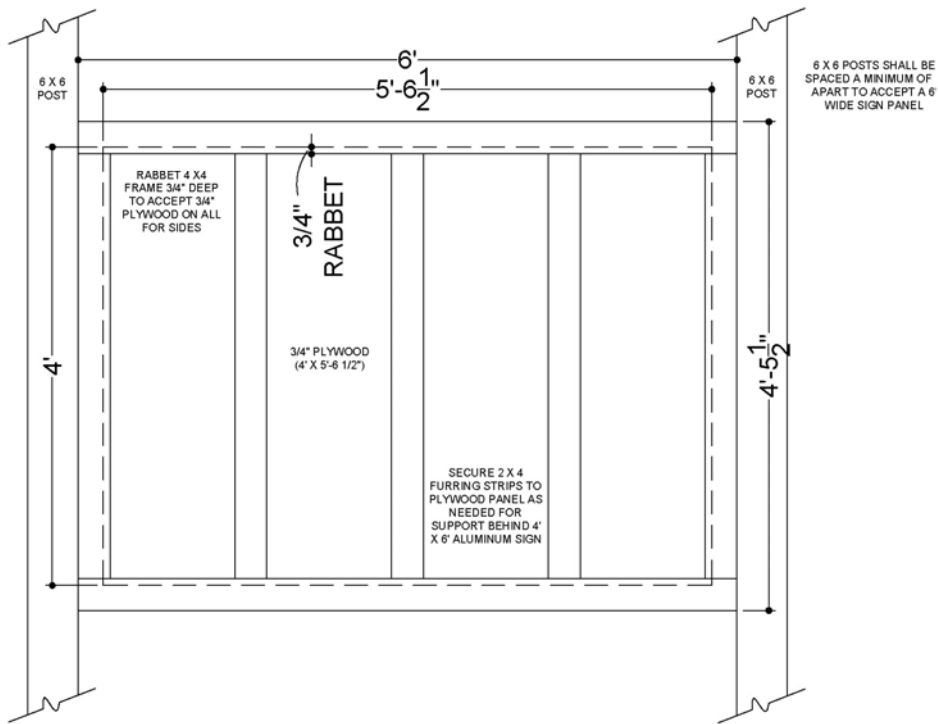

SIGN PANEL

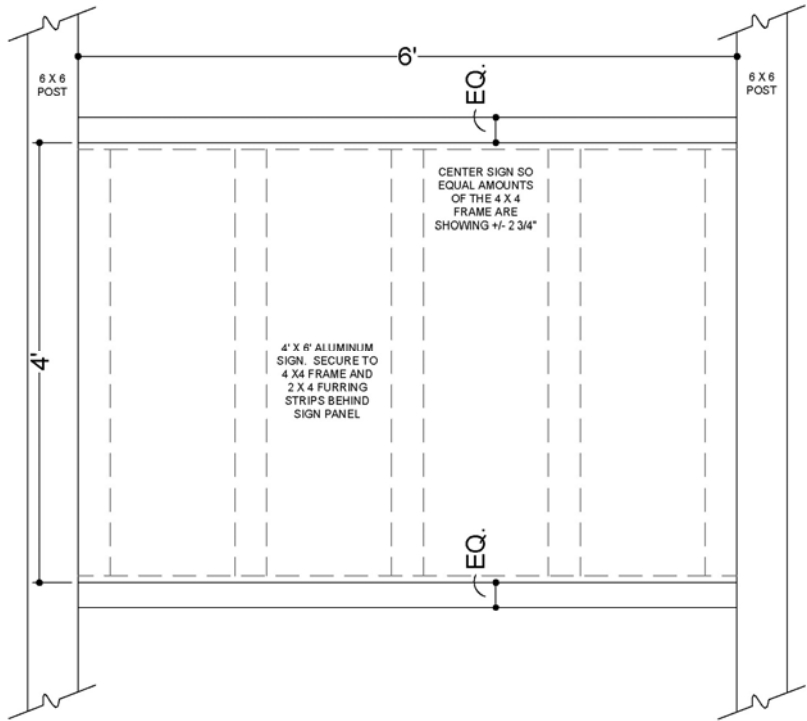

MINOR TRAILHEADS

Minor Trailhead Construction / Design

- 24" x 36" Signabond Lite 3mm Aluminum Composite Sign Panels with 1.5" radius corners shall be secured to unstained 4 x 4 pressure treated sign posts with galvanized screws. 4 holes will need to be drilled in the sign panels for mounting.
- Sign panels shall have a 2-sided, full color imprint, printed on permanent vinyl with luster lam. Back of sign shall be Dark Blue PMS 647C.
- "You are Here" symbols will be part of the graphic sign panel and will not be added after installation.
- Minor trailhead structures require two 4 x 4 posts.
- A trail intersection identifier number shall be located at the top of the left sign post.

X-Country Ski Minor Trailheads

- Seasonal trailheads shall be located at the start of ski trails. These signs can be removable (ground sleeves required) or permanent. If permanent posts are installed, a replacement sign to fill the space should be installed when not in use.

